

Referenz-Nr. Order No.	L	n	h1	h2	h	o	e	f	b	c	k	i	p H7	Spannmenge Coupling Piece	Spannkraft clamping force kgf	Drehmoment Allowable Screw Torque (N-m)	 (kg)
2430-055300	300	55	50	32	72	12.5	36	65	100	50	100	100	18	2	1750	25	9
2430-055500	500	55	50	32	72	12.5	36	65	100	50	100	300	18	4			15
2430-075400	400	75	65	37	102	12.5	48	77	100	50	100	200	18	2	2000	35	20
2430-075600	600	75	65	37	102	12.5	48	77	100	50	100	400	18	4			33
2430-100400	400	100	65	37	102	12.5	48	80	100	50	100	200	18	2	2500	50	27
2430-100600	600	100	65	37	102	12.5	48	80	100	50	100	400	18	3			41

2430

- Spannen mehrerer Werkstücke möglich
- Formanpassung möglich
- Feinbeschichtung
- Backen müssen separat bestellt werden.

2430

- It provides the attachments of more than one workpieces to the product. Jaws are modular and can be adjusted to the desired measurement.
- Form of the workpiece can be applied on the soft legs connected to the groups.
- Sensitive Grinding
- You need to purchase jaws separate.

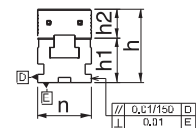
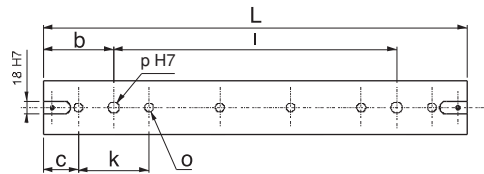
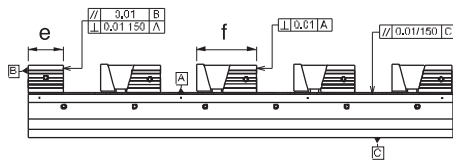

Referenz-Nr. Order No.	Spannmengen / Numbers of Portable Jaw with Workpiece Couplings				
	1 Werkstück 1 Workpiece	2 Werkstück 2 Workpiece	3 Werkstück 3 Workpiece	4 Werkstück 4 Workpiece	5 Werkstück 5 Workpiece
2430-055300					
2430-055300	196mm	65mm	22mm	-	-
2430-055500	394mm	165mm	88mm	50mm	26mm
2430-075400	268mm	95mm	38mm	9mm	-
2430-075600	472mm	197mm	106mm	60mm	32mm
2430-100400	265mm	93mm	35mm	-	-
2430-100600	469mm	195mm	103mm	57mm	30mm

Hinweis: Bei den Werkstückmaßen sind die weichen Backen nicht inkludiert. **Note:** It does not include binding units of measure soft feet in business.

