

| Referenz-Nr. Order No. | | c | L | L1 | L2 | L3 | b | b1 ±0.01 | n | k | k1 | k2 | d | d1 | d2 | sw | Spannkraft clamping force Kgf | Drehmoment Allowable Screw Torque (N-m) | |
|---------------------------|----|---|-----|----|----|----|----|-------------|----|----|----|----|-----|-----|-----|----|-------------------------------------|---|-------|
| 2050-14 | 14 | 5 | 110 | 90 | 85 | 65 | 41 | 18 | 47 | 47 | 26 | 26 | M12 | M12 | M12 | 6 | 1000 | 15 | 5920 |
| 2050-16 | 16 | | | | | | | | | | | | | | | | | | 6210 |
| 2050-18 | 18 | | | | | | | | | | | | | | | | | | 8090 |
| 2050-20 | 20 | | | | | | | | | | | | | | | | | | 8440 |
| 2050-22 | 22 | 5 | 115 | 95 | 85 | 65 | 46 | 18 | 57 | 52 | 26 | 26 | M12 | M12 | M12 | 8 | 1250 | 20 | 8825 |
| 2050-24 | 24 | | | | | | | | | | | | | | | | | | 10080 |
| 2050-28 | 28 | | | | | | | | | | | | | | | | | | 10750 |



2050

- Wenn das Produkt das Werkstück in spannt, führt dies nicht zu einer Veränderung der ursprünglichen Form des Werkstücks. Aufgrund der Parallelität kann der Bohrprozess auf das bearbeitete Teil angewendet werden.
- Gehärtet
- Schwarz beschichtet
- Set in Plastikbox

2050

- When the product clamps the work piece in the direction of rest, it does not cause alteration in the genuine structure of the piece. Because of being with parallel, hole process can be applied on the machined piece.
- Hardened
- Black coating
- Set is in the plastic box

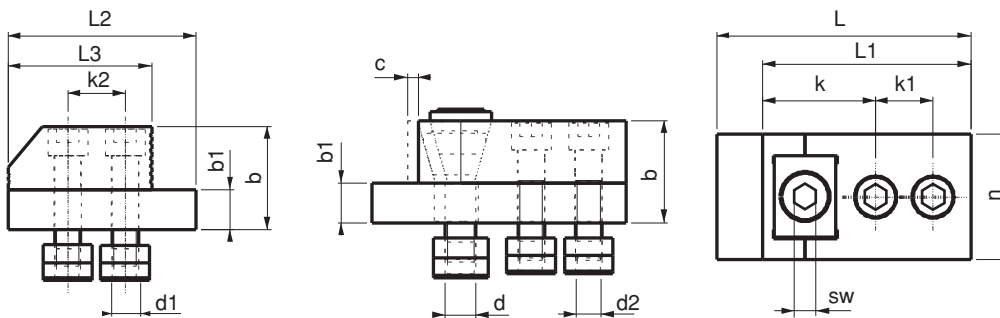

| Set-Inhalt / The set consists of | | | | | | |
|----------------------------------|---|---|----|----|---|---|
| Teil Part | | | | | | |
| Menge Quantity | 2 | 2 | 10 | 10 | 2 | 1 |

