

Referenz-Nr. Order No.		c	L	b	n	k	k1	k2	L1	d	d1	d2	sw	Spannkraft clamping force kgf	Drehmoment Allowable Screw Torque (N-m)	 (g)
2030-14	14	5	90	23	47	47	26	26	65	M12	M12	M12	10	2000	35	3490
2030-16	16															3670
2030-18	18															5000
2030-20	20															5355
2030-22	22	5	95	28	57	52	26	26	65	M12	M12	M12	10	2000	35	5720
2030-24	24															6190
2030-28	28															6650



### 2030

- Wenn das Produkt das Werkstück in spannt, führt dies nicht zu einer Veränderung der ursprünglichen Form des Werkstücks.
- Gehärtet
- Schwarz beschichtet
- Set in Plastikbox

### 2030

- When the product clamps the work piece in the direction of rest, it does not cause alteration in the genuine structure of the piece.
- Hardened
- Black coating
- Set is in the plastic box

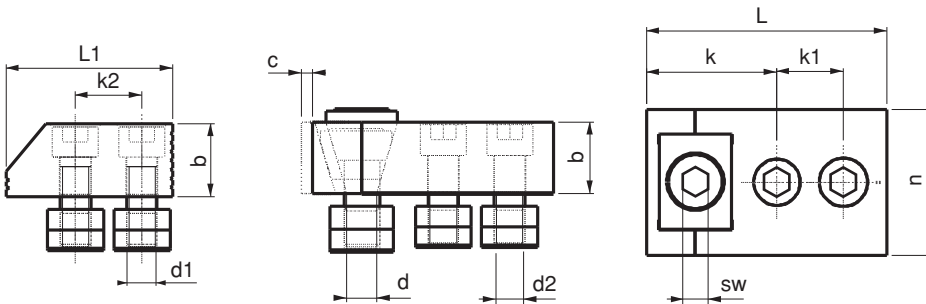

Set-Inhalt / The set consists of						
Teil Part						
Menge Quantity	2	2	10	10	1	1

