

Referenz-Nr. Order No.	h	Ø d	 (g)
1555	10	37	75

**1555**

- Vorteil bei winkligen Oberflächen
- Schwarz beschichtet

**1555**

- This part provides usage convenience on angled surfaces
- Black Coating

Zubehör für Richt- und Stützelemente kompatibel mit  
Nr. 1510 + 1517 + 1530 + 1550

These products are used with the product Nos 1510-1517-1530-1550  
taking place.

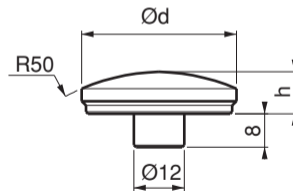
**Kugelaufsatz**  
Rad-top Support