

Referenz-Nr. Order No.	a	$\varnothing b_{h7}$	c	d	e	f	g	m	m1	j	Spannkraft Clamping Force Kgf	 (g)
1280-3010	30	22	58	80	28	16	30	M10	M8	23	750	220
1280-5012	50	26	70	90	32	20	40	M12	M12	40	1100	400
1280-6016	60	32	74	95	40	25	40	M16	M16	45	1250	610

### 1280

- Verwendung in engen Bereichen, auf Platten
- Gehärtet
- Schwarz beschichtet

### 1280

- Function working in restricted areas and variety application at plate
- Hardened
- Black coated

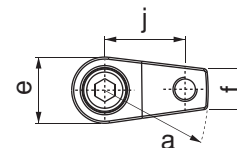
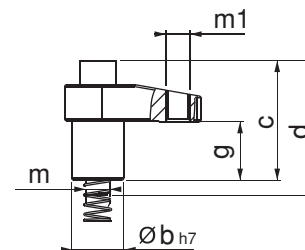

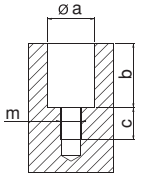
Referenz-Nr. Order No.	a (F7)	b	c	m	
1280-3010	22	30	20	M10	
1280-5012	26	40	25	M12	
1280-6016	32	40	25	M16	

