

Referenz-Nr. Order No.	Spann-Type Mounting Type	Spannarm Clamping Arm	Max. Druck Max. Pressure	Normaldruck Normal Pres.	Bewegungs-Type Acting Type	Drehwinkel Swivel Angle	Drehhub Swivel Stroke (mm)	Spannhub Clamp. Str. (mm)	Bohrdurchmesser Diameter Ø (mm)	Kolbenstange Piston Rod Ø	Spannkraft Force (25kg/cm <sup>2</sup> )	A (mm) Lösen Unclamp	B (mm)	C (mm)	D (mm)	G (mm)	H (mm)	L1 Spannen / Clamp L2 Lösen / Unclamp	N (mm)	P (mm)	Q (mm)	R (mm)	S (mm)	O-Ring Manifold O-Ring	M (mm)	F (mm)	Gewicht Weight (kg)
1043-NHS025	Bottom Flange	1-Arm / Single Arm	70 kg/cm <sup>2</sup>	20-45 kg/cm <sup>2</sup>	doppelseitige Bewegung / Double Acting	90° (0° 45°, 60°, 180°) ± 2°	12	14	25	18	59	100	70	23	□ 25.4	50	10	1/8 PF	M10 x1.5	40	50	Ø 6.5	Ø 45	S4	18	15	0.8
1043-NHS032							14	15	32	20	125	111	76	25	□ 25.4	55	10	1/8 PF	M10 x1.5	44	55	Ø 6.5	Ø 50	S4	24	17	1.0
1043-NHS040							14	15	40	20	200	113.6	80	27	□ 25.4	55	10	1/8 PF	M10 x1.5	48	62	Ø 8.5	Ø 54	S4	26	20	1.1
1043-NHS050							14	15	50	20	400	114.5	80	27	□ 25.4	55	10	1/8 PF	M10 x1.5	57	74	Ø 8.5	Ø 65	S4	30	25	1.4
1043-NHS063							14	15	63	25	600	118	85	32	□ 32	75	11	1/8 PF	M12 x1.75	70	88	Ø 10.5	Ø 80	S4	40	30	2.3

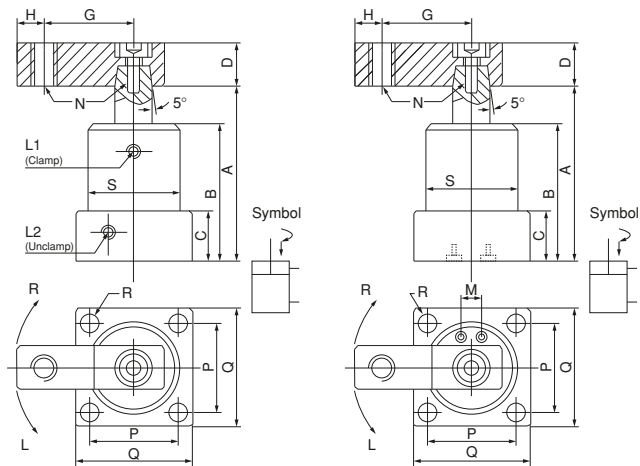

### 1043

NHS – Flanschversion, 1-Arm  
Mit Rohr oder Verteiler

NHS – Flange Version, Single Arm  
With Pipe or Manifold

- Bei Bestellung bitte Bewegungs-Type und Drehwinkel angeben.
- Before buying please, movement indicate the type and rotation angle.

