

Referenz-Nr. Order No.	a	b	c	 (g)
1120-DP	13.5	26.5	12	15
1120-BSP	15.5	26.5	12	18
1120-ESP	18	26.5	12	21
1130-DP	17	32	15	20
1130-BSP	19	32	15	30
1130-ESP	22	32	15	30
1150-DP	19	38	18	40
1150-BSP	21	38	18	40
1150-ESP	25	38	18	50
1160-DP	22	44	22	55
1160-BSP	25	44	22	70
1160-ESP	28	44	22	80

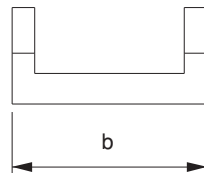

DP

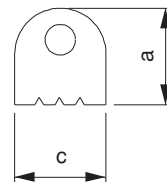

BSP



ESP



### 1120-1130-1150-1160

- DP: Spannen flacher Werkstücke
- BSP: zylindrisch spannen in der Länge
- ESP: zylindrisch spannen in der Breite
- Schwarz beschichtet

### 1120-1130-1150-1160

- Product DP : Straight piece clamping
- Product BSP: Longitudinal cylinder clamping
- Product ESP: Lateril cylinder clamping
- Black Coating