

Referans Nr.	P(N)	D	H (0 -1)	D1	H1	A Haraket Travel	d (+0.1 0)	
1473-06002	76	10	11	6	10.7	1	10	4
1473-08002	102	12	13	8	13.9	1.3	12	8
1473-10002	204	16	17	10	16.7	1.6	16	16

## Sıkıştırma Pimi Spring Locating Pins

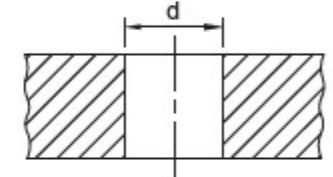

2

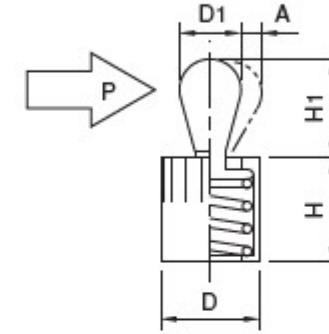

Montaj Deliği  
Installation Hole

### Ürün Nr. 1473 Sıkıştırma Pimi

#### Özellikler

- Geçici bir iş bağlama profili için idealdir.

#### Not

- Pimin hareket etmesi için gerekli olan minimum "P" değeri
- Parça : 90 °C'ye kadar

### Product Nr. 1473 Spring Locating Pins

#### Features

- Ideal for temporary clamping of low-profile workpieces.

#### Note

- The stated value "P" denotes the minimum force needed to move the pin.
- Heat resistance : 90 °C

### Kullanım Şekli / How To Use

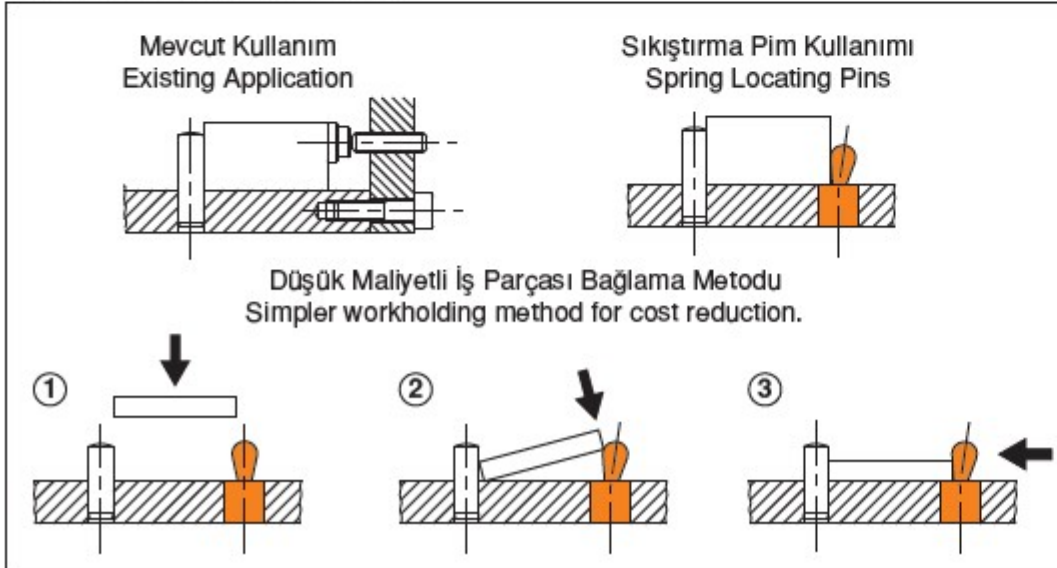

### Çeşitli Uygulamalar / Application Examples

