

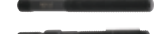

CİVATALAR

BOLTS



	Kalite Dayanım Sınıfları Quality Strength Classes		
	10	10.9	12.9
DIN 787 	-	-	X
DIN 6379 	-	X	-
DIN 6330B DIN 6331 Nr. 1830 	X	-	-
Sembol gerilme mukavemeti [N/mm ²] Nominal tensile strength [N/mm ²]	1000	1000	1200
Minimum akma noktası [N/mm ²] Minimum yield point [N/mm ²]	-	900	1080

Çizelge Özelliklerinin Açıklanması:

- **İzin Verilen Civata Yüğü** : Maksimum gerilim yükü ve vida hesabı alınarak vurgu yapıldı. Aktif kuvvetler, akma noktası, sadece güvenlik için %80 kullanılır.
- **İzin Verilen Ön Gerilme Kuvveti** : Yük, vida ve somun uygulamasında, tablodaki rakamların sürtünmeye karşılık, itme yüzeyleri ve parçanın $\mu = 0,14$ sürtünme kat sayısı geçerlidir.
- **İzin Verilen Ön Gerilme Kuvveti Yağlı Hesaplama** : Yük, vida ve somun uygulamasında, parçanın $\mu = 0,1$ sürtünme kat sayısı hesaplanmalıdır.

Explanation Of Table Characteristics:

- **Permissible Bolt Load** : is the maximum tension load, the screw can be stressed with taking into account all active forces. The yield point is only utilized to 80% for safety.
- **Permissible Pre-stress Force** : is the load, the screw can be pre-stressed at most, when tightening the matching nut. Figures of table are valid for a friction of $\mu = 0,14$ in thrust faces and thread, corresponding to the friction of greased medium faces.
- **Allowed pretension with oil calculation** : At an application with screws and nuts, the load must be calculated with a $\mu = 0,1$ frictional factor of the workpiece.

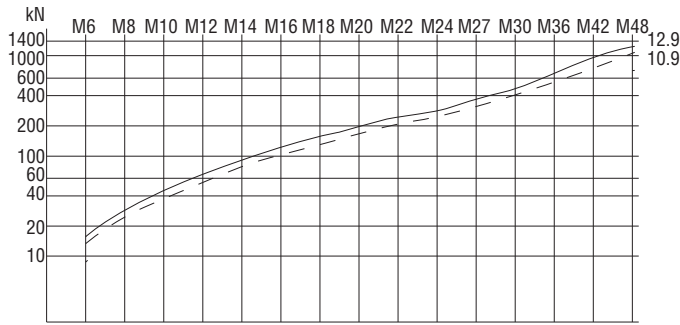

Standart Anahtar İle Öngerilme Kuvveti
Pre-stress Force With Standard Spanner

Civata ve Somun İçin Mukavemet 10.9 ve 12.9 Kalite ve Momentleri / Strength Figures And Torques For Bolts And Nuts:

Diş / Threads	Kalite Quality	M6	M8	M10	M12	M14	M16	M18	M20	M22	M24	M27	M30	M36	M42	M48	
Hatve / Pitch of thread	mm	1	1.25	1.50	1.75	2	2	2.50	2.50	2.50	3	3	3.50	4	4.50	5	
Somun / Nuts																	
Sertlik / Hardness DIN 6330 / 6331 / 6334	HRC	10	28-32														
Test Kuvveti (AS x Sp) Test force DIN EN 20898-2	kN	10	20.9	38.1	60	88	121	165	203	260	321	374	486	595	866	-	-
"T" Pabuç DIN 508 / Nr. 1710 Nuts for T-Slots DIN 508 / Nr. 1710																	
Ölçü / Size		M6x8	M8x10	M10x12	M12x14	-	M16x18	-	M20x22	-	M24x28	-	M30x36	M36x42	M42x48	M48x54	
Sertlik / Hardness	HRC	22 - 30															
Test Kuvveti / Test Force	kN	16	29	46	67	-	128	-	196	-	282	-	448	653	653	653	
Civata / Bolts																	
Sertlik / Hardness	HRC	10.9														32 - 39	
		12.9														39 - 44	

Sıkma Verileri / Tightening Data

Minimum Kırılma Kuvveti Minimum Breaking Force (AS x Rm)	kN	10.9	21	38	60	88	(120)	(163)	(200)	(255)	(315)	(367)	(477)	(583)	(850)	(1165)	(1531)	
		12.9	(24)	(45)	71	103	(140)	192	(234)	299	(370)	431	(560)	(684)	(997)	(1367)	(1797)	
İzin verilen civata yükü max. Verim noktası % 80	Permissible bolt load max. 80% of yield point	kN	10.9	14	27	43	63	86	118	144	184	228	265	345	421	614	843	1107
			12.9	17	32	51	74	101	138	169	215	266	310	404	493	719	986	1296
(X Sp AS) Test kuvveti DIN EN ISO 898, bölüm 1	Test force (AS x Sp) to DIN EN ISO 898, part 1	kN	10.9	17	30	48	70	(96)	(130)	(159)	(203)	(252)	(293)	(381)	(466)	(678)	(930)	(1222)
			12.9	(20)	(35)	56	82	(112)	152	(186)	238	(294)	342	(445)	(544)	(792)	(1087)	(1428)
İzin verilen ön gerilme kuvveti max. Verim % 90 Nokta ve sürtünme $\mu = 0,14$	Permissible pre-stress force max. 90% of yield Point and friction $\mu = 0,14$	kN	10.9	13	25	38	55	77	107	130	167	208	240	315	384	561	773	1018
			12.9	15	29	44	65	91	125	152	196	243	281	369	449	657	904	1191
Gerilme öncesi müsadde edilen tork değeri Kuvvet ve sürtünme $\mu = 0,14$	Required torque for permissible pre-stress Force and friction $\mu = 0,14$	Nm	10.9	14	36	67	120	191	302	405	580	772	994	1455	1930	3378	5415	8162
			12.9	17	43	79	141	223	354	474	679	903	1163	1703	2258	3953	6337	9571
Müsadde edilen kol uzunluğu ön gerilme kuvveti	Required length for lever to achieve permissible pre-stress force	mm	10.9	42	90	175	300	450	700	920	1200	1560	-	-	-	-	-	-
			12.9	51	110	210	360	550	830	1100	1470	1860	-	-	-	-	-	-
Standart anahtar ile tork değeri elde etmek mümkündür	Possible torque to obtain with standard spanner, resulting	Nm	-	60	80	90	100	110	125	140	150	170	185	225	240	300	330	410
Öngerilme kuvveti	Pre-stress force	kN	-	54	53	48	43	43	43	43	42	42	43	45	43	45	46	50
Bu öngerilme kuvveti ile tehlikesi var	With this pre-stress force there is danger of		10.9	Kırılma breakage		permanent deformation		hareket kuvvetinin başlangıcında bağlama ünitesinin gevşemesi loosening of clamping unit at start of motive force										
			12.9	kalıcı deformasyon														

As = Sembolik kesit mm²
As = Nominal cross section in mm²

Sp = Min. N / mm² cinsinden sıkma kuvveti
Sp = min. Clamping force in N/mm²

Rm = Min. N/mm² yük faktörü
Rm = min. load factor in N/mm²

μ = sürtünme
 μ = friction

Referans Nr.	dx	x L	b	a	e	k	Sıkma Verileri Tightening Data		
							Nm	kN	
1590-0606025		x25	15						8
1590-0606040	M6x6	x40	28	5.7	10	4	17	17	11
1590-0606063		x63	40						15
1590-0808032		x32	22						13
1590-0808050	M8x8	x50	35	7.7	12	6	43	32	16
1590-0808080		x80	50						20
1590-1010040		x40	23						35
1590-1010063	M10x10	x63	45	9.7	15	6	79	51	45
1590-1010080		x80	50						60
1590-1010100		x100	60						70
1590-1012050		x50	35						50
1590-1012063		x63	40						60
1590-1012080		x80	55						65
1590-1012100	M10x12	x100	60	11.7	18	7	79	51	75
1590-1012125		x125	75						90
1590-1012160		x160	90						105
1590-1012200		x200	120						120
1590-1212050		x50	35						65
1590-1212063		x63	40						70
1590-1212080		x80	55						80
1590-1212100	M12x12	x100	65	11.7	18	7	141	74	100
1590-1212125		x125	75						110
1590-1212160		x160	100						140
1590-1212200		x200	120						160
1590-1214050		x50	35						80
1590-1214063		x63	45						90
1590-1214080		x80	55						100
1590-1214100	M12x14	x100	65	13.7	22	8	141	74	110
1590-1214125		x125	75						135
1590-1214160		x160	100						160
1590-1214200		x200	120						180
1590-1416063		x63	45						115
1590-1416080		x80	55						140
1590-1416100		x100	65						160
1590-1416125	M14x16	x125	75	15.7	25	9	223	101	180
1590-1416160		x160	100						220
1590-1416200		x200	120						255
1590-1416250		x250	150						300
1590-1616063		x63	45						140
1590-1616080		x80	55						160
1590-1616100		x100	65						190
1590-1616125	M16x16	x125	85	15.7	25	9	354	138	225
1590-1616160		x160	100						270
1590-1616200		x200	120						315
1590-1616250		x250	150						380
1590-1618063		x63	45						170
1590-1618080		x80	55						185
1590-1618100		x100	65						220
1590-1618125	M16x18	x125	85	17.7	28	10	354	138	245
1590-1618160		x160	100						295
1590-1618200		x200	120						340
1590-1618250		x250	150						405
1590-1820080		x80	55						260
1590-1820100		x100	65						290
1590-1820125		x125	85						340
1590-1820160	M18x20	x160	110	19.7	32	12	474	169	390
1590-1820200		x200	125						455
1590-1820250		x250	150						535
1590-1820315		x315	190						650
1590-2020080		x80	55						300
1590-2020100		x100	65						330
1590-2020125		x125	85						380
1590-2020160	M20x20	x160	110	19.7	32	12	679	215	450
1590-2020200		x200	125						535
1590-2020250		x250	160						635
1590-2020315		x315	190						760
1590-2022080		x80	55						345
1590-2022100		x100	65						380
1590-2022125		x125	85						435
1590-2022160	M20x22	x160	110	21.7	35	14	679	215	500
1590-2022200		x200	125						590
1590-2022250		x250	150						695
1590-2022315		x315	190						820

Referans Nr.	dx	x L	b	a	e	k	Sıkma Verileri Tightening Data		
							Nm	kN	
1590-2224080		x80	55						465
1590-2224100		x100	65						515
1590-2224125		x125	85						580
1590-2224160	M22x24	x160	110	23.7	40	16	903	266	660
1590-2224200		x200	125						775
1590-2224250		x250	150						805
1590-2224315		x315	190						1050
1590-2424100		x100	70						550
1590-2424125		x125	85						630
1590-2424160		x160	110						725
1590-2424200	M24x24	x200	125	23.7	40	16	1163	310	850
1590-2424250		x250	150						990
1590-2424315		x315	190						1180
1590-2424400		x400	240						1410
1590-2428100		x100	70						660
1590-2428125		x125	85						730
1590-2428160		x160	110						820
1590-2428200	M24x28	x200	125	27.7	44	18	1163	310	950
1590-2428250		x250	150						1090
1590-2428315		x315	190						1300
1590-2428400		x400	240						1530
1590-2428500		x500	290						1800
1590-3036125		x125	80						1280
1590-3036160		x160	110						1440
1590-3036200	M30x36	x200	135	35.6	54	22	2258	493	1620
1590-3036250		x250	150						1880
1590-3036315		x315	200						2150
1590-3036500		x500	300						3010
1590-3642160		x160	100						2260
1590-3642250		x250	175						2890
1590-3642400	M36x42	x400	250	41.6	65	26	3953	719	4010
1590-3642600		x600	340						5900
1590-4248160		x160	100						3550
1590-4248250	M42x48	x250	175	47.6	75	30	6337	986	4530
1590-4248400		x400	250						6160

DIN 787
Ürün Nr. 1590 T-Ayaklı Saplama

- Kalite 12.9
- Siyah kaplama

Product Nr. 1590 T-Slot Bolt

- Quality 12.9
- Black coating

 Loctite
8150

Not: 150 °C üzerindeki ortamlarda sıkma işlemi yapılırken dişlerin üzerine Loctite 8150 kullanılır.

Note: Environments on the 150 °C when clamping action on the thread Loctite 8150 is used.

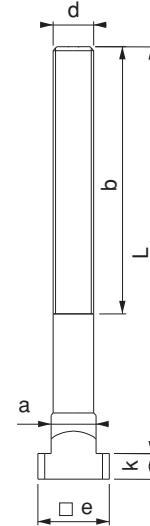

Referans Nr.	dx	x L	b	a	e	k	Sıkma Verileri		Tightening Data	Nm	kN
							Nm	kN			
1610-0606025		x25	15								19
1610-0606040	M6x6	x40	28	5.7	10	4	17	17			25
1610-0606063		x63	40								36
1610-0808032		x32	22								39
1610-0808050	M8x8	x50	35	7.7	12	6	43	32			45
1610-0808080		x80	50								56
1610-1010040		x40	23								65
1610-1010063	M10x10	x63	45	9.7	15	6	79	51			80
1610-1010080		x80	50								90
1610-1010100		x100	60								110
1610-1012050		x50	35								85
1610-1012063	M10x12	x63	40								95
1610-1012080		x80	55								100
1610-1012100		x100	60	11.7	18	7	79	51			110
1610-1012125		x125	75								125
1610-1012160		x160	90								140
1610-1012200		x200	120								160
1610-1212050		x50	35								120
1610-1212063	M12x12	x63	40								128
1610-1212080		x80	55								140
1610-1212100		x100	65	11.7	18	7	141	74			160
1610-1212125		x125	75								170
1610-1212160		x160	100								195
1610-1212200		x200	120								220
1610-1214050		x50	35								140
1610-1214063	M12x14	x63	45								150
1610-1214080		x80	55								155
1610-1214100		x100	65	13.7	22	8	141	74			175
1610-1214125		x125	75								195
1610-1214160		x160	100								220
1610-1214200		x200	120								240
1610-1416063		x63	45								200
1610-1416080	M14x16	x80	55								230
1610-1416100		x100	65								245
1610-1416125		x125	75	15.7	25	9	223	101			270
1610-1416160		x160	100								310
1610-1416200		x200	120								340
1610-1416250		x250	150								390
1610-1616063		x63	45								260
1610-1616080	M16x16	x80	55								285
1610-1616100		x100	65								310
1610-1616125		x125	85	15.7	25	9	354	138			340
1610-1616160		x160	100								385
1610-1616200		x200	120								435
1610-1616250		x250	150								505
1610-1618063		x63	45								290
1610-1618080	M16x18	x80	55								305
1610-1618100		x100	65								340
1610-1618125		x125	85	17.7	28	10	354	138			370
1610-1618160		x160	100								415
1610-1618200		x200	120								460
1610-1618250		x250	150								525
1610-1820080		x80	55								405
1610-1820100	M18x20	x100	65								435
1610-1820125		x125	85								480
1610-1820160		x160	110	19.7	32	12	474	169			535
1610-1820200		x200	125								610
1610-1820250		x250	150								680
1610-1820315		x315	190								790
1610-2020080		x80	55								480
1610-2020100	M20x20	x100	65								515
1610-2020125		x125	85								570
1610-2020160		x160	110	19.7	32	12	679	215			635
1610-2020200		x200	125								725
1610-2020250		x250	160								820
1610-2020315		x315	190								950
1610-2022080		x80	55								530
1610-2022100	M20x22	x100	65								565
1610-2022125		x125	85								620
1610-2022160		x160	110	21.7	35	14	679	215			690
1610-2022200		x200	125								775
1610-2022250		x250	150								880
1610-2022315		x315	190								1050

Referans Nr.	dx	x L	b	a	e	k	Sıkma Verileri		Tightening Data	Nm	kN
							Nm	kN			
1610-2224080		x80	55								700
1610-2224100		x100	65								740
1610-2224125	M22x24	x125	85								805
1610-2224160		x160	110	23.7	40	16	903	266			890
1610-2224200		x200	125								1000
1610-2224250		x250	150								1115
1610-2224315		x315	190								1280
1610-2424100		x100	70								885
1610-2424125	M24x24	x125	85								970
1610-2424160		x160	110	23.7	40	16	1163	310			1060
1610-2424200		x200	125								1180
1610-2424250		x250	150								1320
1610-2424315		x315	190								1515
1610-2424400		x400	240								1750
1610-2428100		x100	70								1000
1610-2428125	M24x28	x125	85								1065
1610-2428160		x160	110	27.7	44	18	1163	310			1150
1610-2428200		x200	125								1280
1610-2428250		x250	150								1425
1610-2428315		x315	190								1640
1610-2428400		x400	240								1870
1610-2428500		x500	290								2170
1610-3036125		x125	80								1900
1610-3036160	M30x36	x160	110								2065
1610-3036200		x200	135	35.6	54	22	2258	493			2250
1610-3036250		x250	150								2500
1610-3036315		x315	200								2770
1610-3036500		x500	300								3630
1610-3642160		x160	100								3310
1610-3642250	M36x42	x250	175								3930
1610-3642400		x400	250	41.6	65	26	3953	719			5010
1610-3642600		x600	340								6900
1610-4248160		x160	100								4600
1610-4248250	M42x48	x250	175	47.6	75	30	6337	986			5600
1610-4248400		x400	250								7200

DIN 787
Ürün Nr. 1610 Somunlu Pullu T-Ayaklı Saplama

- Kalite 12.9
- Siyah kaplama

Product Nr. 1610 T-Slot Bolt with Nut and Washer

- Quality 12.9
- Black coating

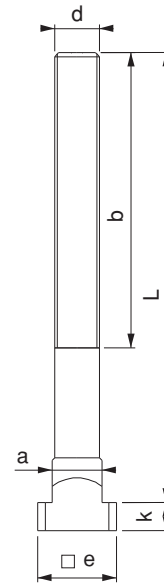

Not: 150 °C üzerindeki ortamlarda sıkma işlemi yapılırken dişlerin üzerine Loctite 8150 kullanılır.



Loctite 8150

Note: Environments on the 150 °C when clamping action on the thread Loctite 8150 is used.

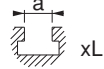
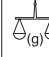
Referans Nr.	dx  xL	a	e	k	h-H	e1	e2	c	s	f	sw	Sıkma Verileri Tightening Data		
												Nm	kN	
1630-2022200	M20x22x200	21.7	35	14	25-75	49	69	92	12	30	30	679	215	1635
1630-2022250	M20x22x250	21.7	35	14	70-120	49	69	92	12	30	30	679	215	1720
1630-2424200	M24x24x200	23.7	40	16	25-75	53	74	92	12	30	36	1163	310	2075
1630-2424250	M24x24x250	23.7	40	16	70-120	53	74	92	12	30	36	1163	310	2250
1630-2428200	M24x28x200	27.7	44	18	25-75	53	74	92	12	30	36	1163	310	2180
1630-2428250	M24x28x250	27.7	44	18	70-120	53	74	92	12	30	36	1163	310	2340
1630-3036200	M30x36x200	35.6	54	22	25-75	68	88	94	14	30	46	2258	493	3660
1630-3036250	M30x36x250	35.6	54	22	70-120	68	88	94	14	30	46	2258	493	3910

Ürün Nr. 1630 Kombine T-Ayaklı Saplama

- Ağır preslerde, büyük kalıplarda çalışma esnasında vibrasyondan kaynaklanan olabilecek gevşemeyi somunun kontra sıkma yapısından dolayı önler
- Kalite 12.9
- Siyah kaplama

Product Nr. 1630 Combined T-Slot Bolt

- Because of it's contra tightening structure, it prevents loosening which may be generated by the vibration during working with heavy presses and big moulds.
- Quality 12.9
- Black coating

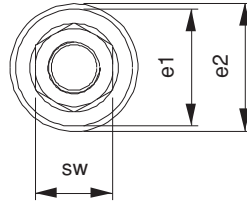
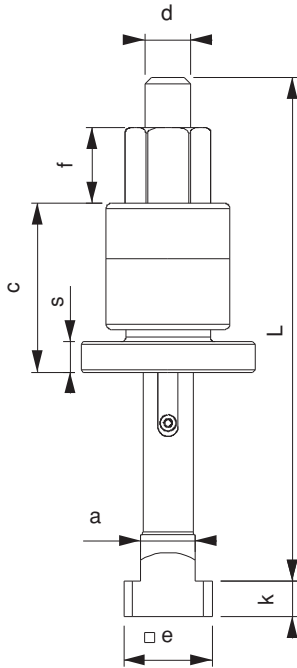

Not: 150 °C üzerindeki ortamlarda sıkma işlemi yapılırken dişlerin üzerine Loctite 8150 kullanılır.

Note: Environments on the 150 °C when clamping action on the thread Loctite 8150 is used.



Loctite
8150

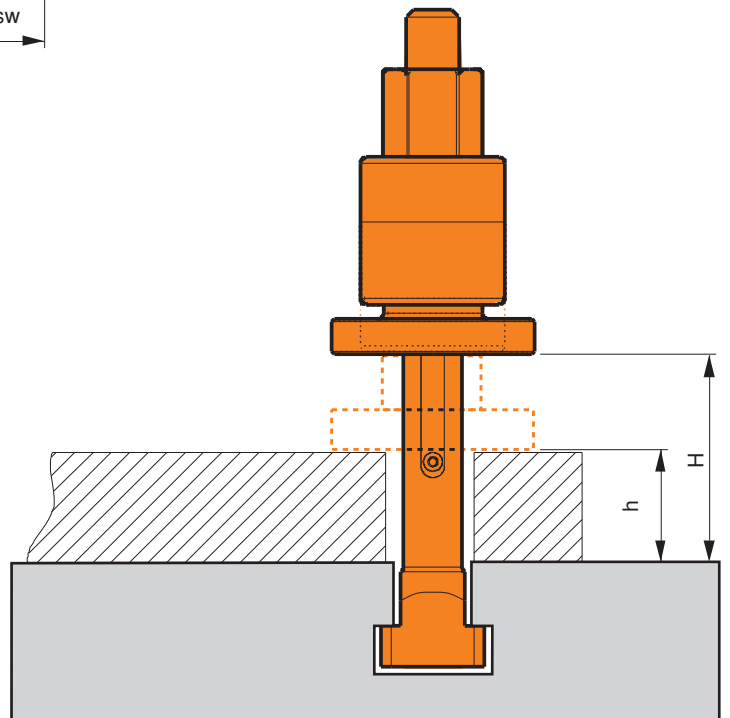

Referans Nr.	dx	x L	b	a	e	k	Sıkma Verileri Tightening Data		
							Nm	kN	
1650-1214050		x50	35						70
1650-1214080	M12x14	x80	55	13.7	22	8	141	74	100
1650-1214125		x125	75						120
1650-1618063		x63	45						160
1650-1618100	M16x18	x100	65	17.7	28	10	354	138	220
1650-1618160		x160	100						280
1650-2022080		x80	55						330
1650-2022125	M20x22	x125	85	21.7	35	14	679	215	430
1650-2022200		x200	120						570
1650-2428100		x100	70						650
1650-2428125	M24x28	x125	85	27.7	44	18	1163	310	770
1650-2428250		x250	150						1150

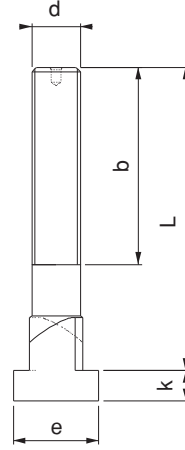

Ürün Nr. 1650 Dereceli T-Ayaklı Saplama

- T-Kanal pleytlerde üstten T-Kanala girip bağlama özelliği vardır
- Kalite 12.9
- Siyah kaplama

Product Nr. 1650 Graded T-Slot Bolt

- In T-Slot plates it has the feature of making the coupling by entering T-Slot the top.
- Quality 12.9
- Black coating

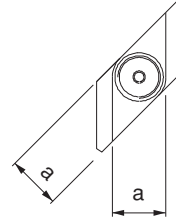

Not: 150 °C üzerindeki ortamlarda sıkma işlemi yapılırken dişlerin üzerine Loctite 8150 kullanılır.



Loctite
8150

Note: Environments on the 150 °C when clamping action on the thread Loctite 8150 is used.

Referans Nr.	d	L	b	b1	m	sw	Sıkma Verileri Tightening Data		
							Nm	kN	
1670-12130		130	65						160
1670-12160	M12	160	90	24	14	14	120	63	185
1670-14130		130	65						216
1670-14160	M14	160	90	28	15	15	191	86	246
1670-16140		140	70						310
1670-16160	M16	160	95	32	16	17	302	118	340
1670-18150		150	70						395
1670-18180	M18	180	95	35	19	19	405	144	450
1670-20150		150	70						520
1670-20180	M20	180	95	40	22	22	580	184	575
1670-22150		150	70						610
1670-22180	M22	180	95	40	22	24	772	228	705
1670-24170		170	75						875
1670-24205	M24	205	105	47	22	27	994	265	990
1670-24250		250	140						1125
1670-30250		250	135						1950
1670-30315	M30	315	195	55	32	36	1930	421	2260

Anahtar Ağızlı Saplama

Wrench Mouth Stud

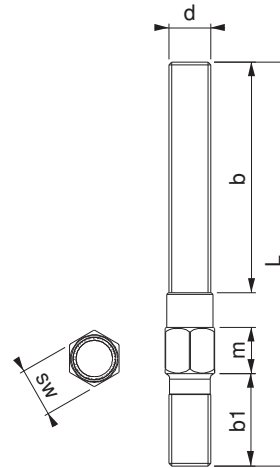

Ürün Nr. 1670 Anahtar Ağızlı Saplama

- Kullanım alanı; Enjeksiyon makinelerinde ve M12-14-16-18-20-22-24-30 diş açılmış pleytlerde kullanılır.
- Kalite 10.9
- Siyah kaplama

Product Nr. 1670 Wrench Mouth Stud

- Area of Use: This stud is used in injection machines and in plates with M12-14-16-18-20-22-24-30 threads
- Quality 10.9
- Black coating





Loctite
8150

Not: 150 °C üzerindeki ortamlarda sıkma işlemi yapılırken dişlerin üzerine Loctite 8150 kullanılır.

Note: Environments on the 150 °C when clamping action on the thread Loctite 8150 is used.



Referans Nr.	d x L	b1	b	Sıkma Verileri Tightening Data		 (g)
				Nm	kN	
1690-08040	M8	11	20	36	27	10
1690-08063			40			15
1690-08080			50			20
1690-08100			63			30
1690-08125			75			35
1690-08160			100			45
1690-10050	M10	13	25	67	43	20
1690-10063			32			25
1690-10080			50			35
1690-10100			63			45
1690-10125			75			55
1690-10160			100			70
1690-10200	125	95				
1690-12050	M12	15	25	120	63	35
1690-12063			32			40
1690-12080			50			55
1690-12100			63			70
1690-12125			75			90
1690-12160			100			115
1690-12200	125	140				
1690-14063	M14	17	32	191	86	60
1690-14080			50			75
1690-14100			63			95
1690-14125			75			120
1690-14160			100			150
1690-14200			125			195
1690-14250	160	240				
1690-16063	M16	19	32	302	118	85
1690-16080			50			105
1690-16100			63			130
1690-16125			75			160
1690-16160			100			205
1690-16200			125			260
1690-16250	160	325				
1690-16315	180	405				
1690-16500	315	650				
1690-18080	M18	23	50	405	144	130
1690-18100			60			160
1690-18125			75			200
1690-18160			100			260
1690-18200			125			320
1690-18250			150			400
1690-18315	180	510				
1690-20080	M20	27	32	580	184	155
1690-20100			60			200
1690-20125			70			250
1690-20160			100			330
1690-20200			125			400
1690-20250			160			510
1690-20315	200	640				
1690-20400	250	815				
1690-20500	315	1020				
1690-22100	M22	31	45	772	228	250
1690-22125			70			305
1690-22160			100			400
1690-22200			125			500
1690-22250			160			620
1690-22315			180			780
1690-22400	250	1010				
1690-24100	M24	35	45	994	265	290
1690-24125			70			365
1690-24160			100			470
1690-24200			125			580
1690-24250			160			730
1690-24315			200			920
1690-24400	250	1170				
1690-24500	315	1470				
1690-24630	315	1860				
1690-30125	M30	43	56	1930	421	570
1690-30200			125			910
1690-30250			160			1150
1690-30315			200			1435
1690-30500			315			2315
1690-30700			400			3215
1690-301000	x1000	400	4700			

Referans Nr.	d x L	b1	b	Sıkma Verileri Tightening Data		 (g)
				Nm	kN	
1690-36160	M36	51	80	3378	614	1100
1690-36200			125			1340
1690-36250			160			1710
1690-36315			200			2150
1690-36400			250			2700
1690-36500			315			3450
1690-36700	400	4750				
1690-42315	M42	59	200	5415	843	2950
1690-42400			250			3750
1690-42500			315			4690

DIN 6379
Ürün Nr. 1690 Düz Saplama

- Kalite 10.9
- Siyah kaplama

Product Nr. 1690 Straight Stud

- Quality 10.9
- Black coating

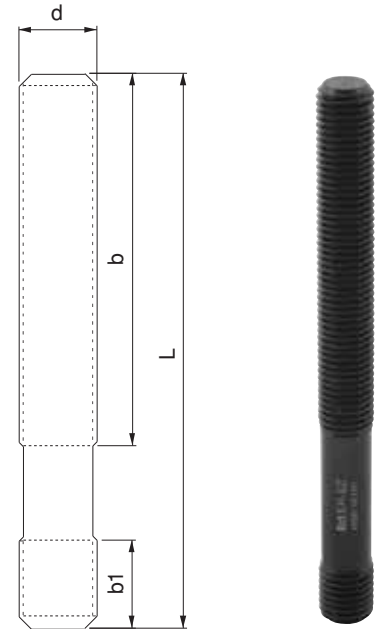

Not: 150 °C üzerindeki ortamlarda sıkma işlemi yapılırken dişlerin üzerine Loctite 8150 kullanılır.

Note: Environments on the 150 °C when clamping action on the thread Loctite 8150 is used.

