

Sets

Sets

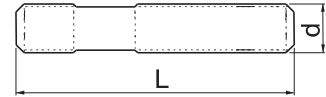

Referenz-Nr. Order No.				DIN 6379 d x L
1990-1012	M10x12	265x255	6.44	M10x80-100-160-200
1990-1214	M12x14	305x255	8.72	M12x80-100-160-200
1990-1416	M14x16	435-255	12.98	M14x80-100-160-200
1990-1618	M16x18	435-255	16.30	M16x80-100-160-200
1990-1820	M18x20	495x255	17.82	M18x80-100-160-200
1990-2022	M20x22	540x255	23.10	M20x100-125-160-200



1990

• Dies ist ein aus Stahl hergestellte Spannelemente-Satz, um das Werkstück oder die Vorrichtungen schnell und sicher auf dem Tisch zu spannen.

1990

• This is the coupling set produced from steel product in order to couple the work piece or apparatuses on the table in a rapid and safe way.

Nr.	L	b1		a	e2	b2
1330	80	11	M10	15	30	30
1330	100	14.5	M12-M14	20	40	40
1330	125					
1330	125	18.5	M16-M18	25	45	50
1330	160					
1330	160	22.5	M20-M22	30	60	60
1330	200					

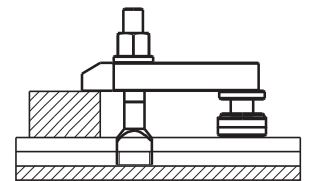
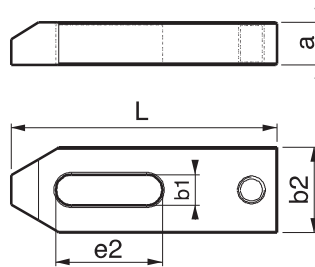

	DIN 508	DIN 6330 B	Nr 1830	DIN 6331	DIN 6340
12	M10	M10	M10	M10	M10
14	M12	M12	M12	M12	M12
16	M14	M14	M14	M14	M14
18	M16	M16	M16	M16	M16
20	M18	M18	M18	M18	M18
22	M20	M20	M20	M20	M20



Nr.		
1950		12-14 16-18 20-22

Nr.	h	H	d	D
1510	23	30	M16	34
1510	40	60	M16	34
1510	70	100	Tr 30x4	50
1510	100	140	Tr 30x4	50

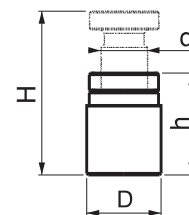



Set-Inhalt

- 6 St T-Backen DIN 508 (M20x22 4 St)
- 16 St Bolzen DIN 6379
- 6 St Mutter DIN 6330B
- 4 St Mutter mit Scheibe DIN 6331
- 2 St Verlängerungsmutter Nr. 1830
- 4 St Scheibe DIN 6340
- 4 St. Backen Nr. 1330
- 8 St. Höhen-Richtschraubstock Nr. 1510
- 1 St. Nutenräumer 1950
- 1 St Stahlset lackiert
- Hinweis : 1990-2022= 6kt-Mutter und Scheibe = 4 St
- 1990-1012 und 1990-1214= 6 St. Höhen-Richtschraubstock 1510

Product: 52 piece set

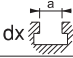
- 6 pieces of DIN 508 T-Nut (M20x22 4 piece)
- 16 pieces of DIN 6379 Stud
- 6 pieces of DIN 6330B Supported Nut
- 4 pieces of DIN 6331 Nut with Washer
- 2 pieces of No. 1830 Extension Nut
- 4 pieces of DIN 6340 Thick Washer
- 4 pieces of No. 1330 Clamp with Support Hole
- 8 pieces of No. 1510 Screw Thread Lifter Support
- 1 piece of No. 1950 T-Slot Scraper
- 1 piece of Steel Set with Statical Paint
- Note: 1990-2022= Hexagon nut and washer = 4 pcs
- 1990-1012 and 1990-1214= 1510 support 6 pcs

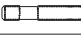
Referenz-Nr. Order No.			 (kg)	 DIN 6379 d x L
2010-1012	M10x12	330x255	7.27	M10x80-100-160-200
2010-1214	M12x14	380x255	9.26	M12x80-100-160-200
2010-1416	M14x16	435x255	12.29	M14x80-100-160-200
2010-1618	M16x18	435x255	15.62	M16x80-100-160-200
2010-1820	M18x20	495x255	18.00	M18x80-100-160-200





2010

- Dies ist ein aus Stahl hergestellte Spannelemente-Satz, um das Werkstück oder die Vorrichtungen schnell und sicher auf dem Tisch zu spannen.



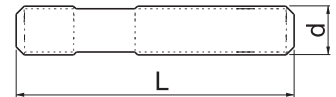

2010

- This is the coupling set produced from steel product in order to couple the work piece or apparatuses on the table in a rapid and safe way.

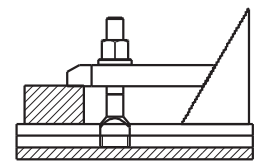
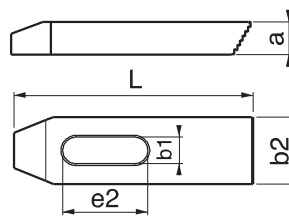

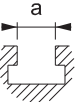
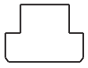
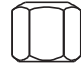
Nr.	L	b1		a	e2	b2
1290	80 100	11	M10	15	30 45	30
1290	100 125	14.5	M12-M14	20	45 55	40
1290	125 160	185	M16-M18	25	65 65	50

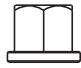

					
	DIN 508	DIN 6330 B	Nr 1830	DIN 6331	DIN 6340
12	M10	M10	M10	M10	M10
14	M12	M12	M12	M12	M12
16	M14	M14	M14	M14	M14
18	M16	M16	M16	M16	M16
20	M18	M18	M18	M18	M18

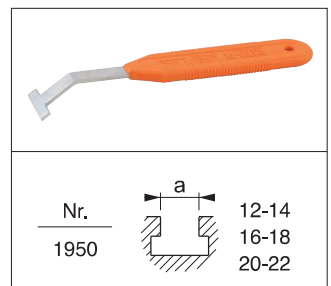

Nr.	h-H	a	min-max
1310	37-85	57	0-40
1310	48-112	73	0-60
1310	58-139	90	0-75
1310	66-165	108	0-90

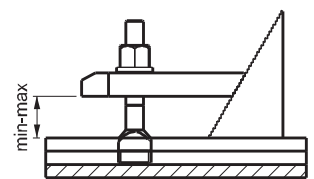
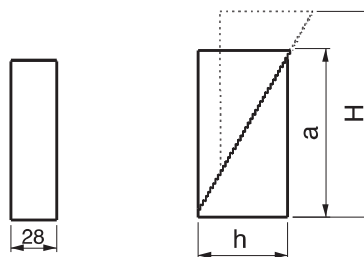

Set-Inhalt

- 6 St T-Backen DIN 508 (M20x22 4 St)
- 16 St Bolzen DIN 6379
- 6 St Mutter DIN 6330B
- 4 St Mutter mit Scheibe DIN 6331
- 2 St Verlängerungsmutter Nr. 1830
- 4 St Scheibe DIN 6340
- 4 St Spanneisen mit Treppenzähnen Nr. 1290
- 8 St Spannunterlagen mit Treppenzähnen Nr. 1310
- 1 St. Nutenräumer 1950
- 1 St Stahlset lackiert

Product: 52 piece set

- 6 pieces of DIN 508 T-Nut (M20x22 4 piece)
- 16 pieces of DIN 6379 Stud
- 6 pieces of DIN 6330B Supported Nut
- 4 pieces of DIN 6331 Nut with Washer
- 2 pieces of No. 1830 Extension Nut
- 4 pieces of DIN 6340 Thick Washer
- 4 pieces of No. 1290 Serrated Clamp
- 8 pieces of No. 1310 Clamp with Support Hole
- 1 piece of No. 1950 T-Slot Scraper
- 1 piece of Steel Set with Statical Paint

Referenz-Nr. Order No.			Tork Torque Nm	Spannkraft clamping force kgf	L	m	n	
2020-120125	M12	14-16-18	45	1500	125	20	15	1414
2020-120250	M12		45	1500	250	20	15	1528
2020-120500	M12		45	1500	500	20	15	1755
2020-121000	M12		45	1500	1000	20	15	2210
2020-160125	M16	18-20-22-24	90	4000	125	33	21	3495
2020-160250	M16		90	4000	250	33	21	3810
2020-160500	M16		90	4000	500	33	21	4480
2020-161000	M16		90	4000	1000	33	21	5820

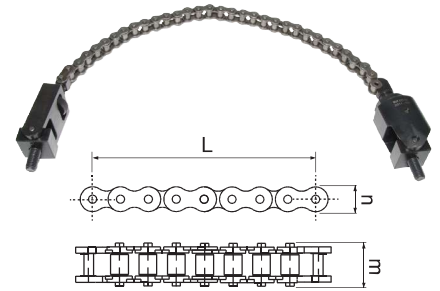

- 2020**
- konstruiert für zylindrische und ovale Werkstücke
 - Gehärtet
 - Schwarz beschichtet

- 2020**
- It is designed for clamping of cylinder and oval workpieces.
 - Hardened
 - Black coating

Referenz-Nr. Order No.		a	b	c	e1	f1	h1 min	h1 max	m	s1	Spannkraft clamping force kgf	
2020-12125	14-16-18	36	36	18	49	21	96	125	M12	35	1500	580
2020-16162	18-20-22-24	37	44	25	64	29	117	162	M16	45	4000	1275

- 2020**
- Gehärtet
 - Schwarz beschichtet

- 2020**
- Hardened
 - Black coating

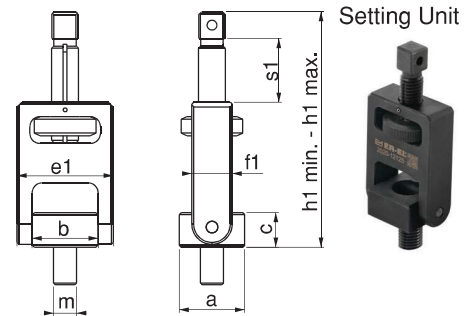

Referenz-Nr. Order No.		a	b	c	e2	f2	h2 min	h2 max	m	s2	SW	Tork Torque Nm	Spannkraft clamping force kgf	
2020-12127	14-16-18	36	36	18	54	49	111	127	M12	16	36	45	1500	945
2020-16170	18-20-22-24	37	44	25	70	62	140	170	M16	30	46	90	4000	1890

- 2020**
- Gehärtet
 - Schwarz beschichtet

- 2020**
- Hardened
 - Black coating

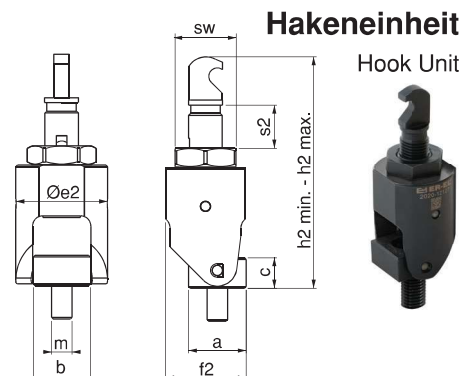
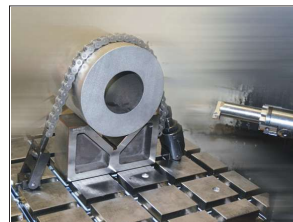

Referenz-Nr. Order No.	L1	L2	
2020-127	127-173	97	350
2020-164	164-225	126	800

- 2020**
- Zur Vorbeugung Kettenknick
 - Gehärtet
 - Schwarz beschichtet

- 2020**
- Used to prevent chain buckling.
 - Hardened
 - Black coating

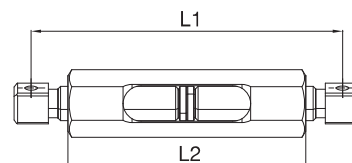

Referenz-Nr. Order No.	SW	SW1	
2020-36	36	1/2	320
2020-46	46	1/2	520

- 2020**
- Sertleştirilmiş
 - Siyah kaplama

- 2020**
- Hardened
 - Black coating

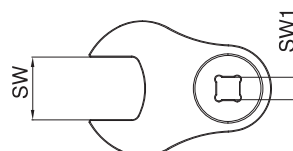

Schraubenschlüssel

Torque Wrench Socket

